

Courses and Distances of }
No. 2.

- N. 5 E. 10.
- S. 86 E. 7 1/2
- S. 27 E. 23.
- S. 48 E. 15.
- S. 59 E. 40.
- S. 40 E. 30.
- S. 20 E. 22
- S. 7 E. 36
- S. 3 E. 48
- S. 8 W. 28
- N. 45 W. 25
- N. 48 W. 58.
- N. 25 W. 11.
- N. 20 W. 14.
- N. 14 W. 60.
- N. 10 W. 40.
- N. 7 W. 20

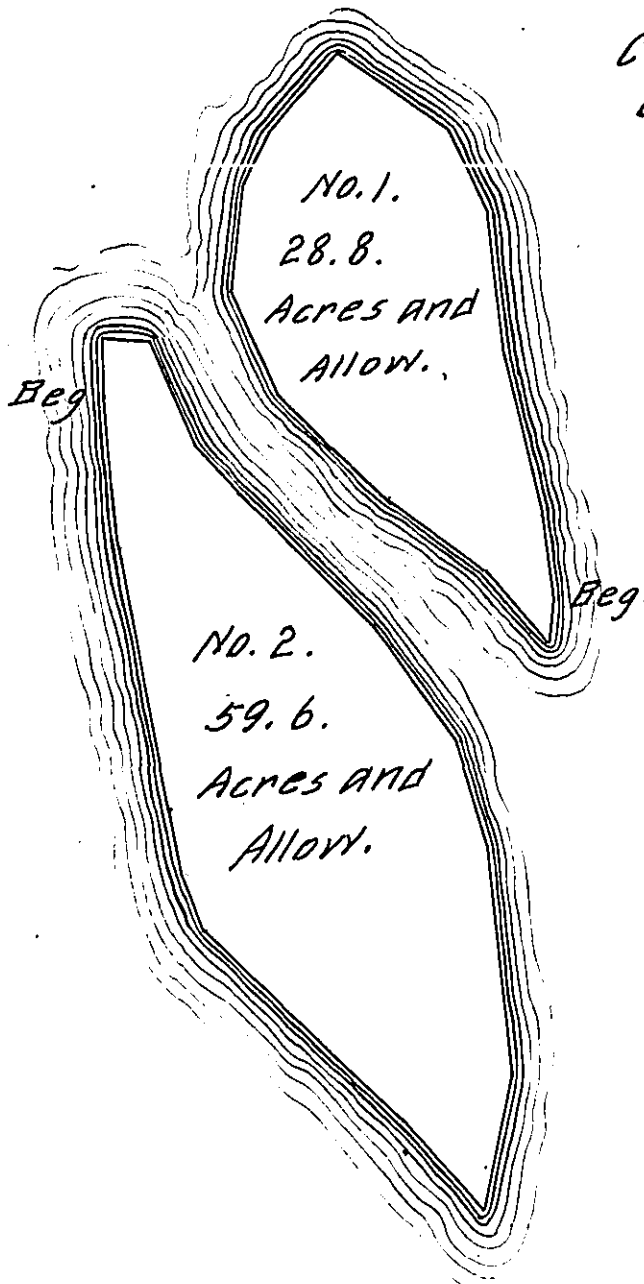

Courses & Distances of No. 1.

- S. 5 W. 10.
- N. 50 W. 22.
- N. 56 W. 26
- N. 60 W. 16
- N. 47 W. 16
- N. 30 W. 24.
- N. 3 E. 21 1/2
- N. 10 E. 12
- N. 40 E. 24.
- S. 62 E. 30.
- S. 35 E. 18.
- S. 11 E. 26.
- S. 23 E. 38.
- S. 4 E. 20.

The Draughts of Two Islands in the River Susquehanna above Logan's Island and nearly opposite the Middle of the Isle of Que in the County of Northumberland, containing No. 1. Twenty Eight Acres and 134 Perches with the usual Allow. No. 2. Fifty nine Acres 110 Perches with the usual Allowance. Survey'd the 29th day of May Anno Domini 1775 For the Honble the Proprietaries of the Province of Pennsylvania. in Pursuance of their Warrant for that Purpose. Bearing Date at Philada the 13th day of October Anno Domini. 1760.

To John Lukens. Esqr. }
S. G of Pennsylvania }

p. Wm. Maclay.

IN TESTIMONY that the above is a copy of the original remaining on file in the Department of Internal Affairs of Pennsylvania, made conformably to an Act of Assembly approved the 16th day of February, 1833, I have hereunto set my Hand and caused the Seal of said Department to be affixed at Harrisburg, this twelfth day of April 1910

Henry Horner
Secretary of Internal Affairs.